

Pipe slides type DS-2 with two pipe clamps, DIN 3567

Field of application

- Attachment of pipelines preferably with insulation in heavy-duty building technology, industrial construction and plant engineering
- Preferred for insulated pipes lines
- For insulation thicknesses up to 140 mm

Advantages

- Special lengths are available upon request
- Also available with polyamide sliding plate upon request
- Also available in stainless steel as well as in primer coated version upon request



Nominal size DN	Pipe outer diameter D1 [mm]	Part no.		Sales unit	Pack unit
		W37-OR-SG	W37-OF-SF		
175	191.0	115980	116254	1	pieces
	193.7	115982	116260		
200	216.0	115985	116266		
	219.1	115989	116272		
250	267.0	115992	116278		
	273.0	115995	116284		
300	315.0	115998	116290		
	323.9	116001	116296		
350	355.6	116004	116302		
	368.0	116007	116309		
400	406.4	116010	116315		
	419.0	116013	116321		
500	508.0	116016	116327		
	521.0	116019	116333		
600	610.0	116022	116339		

Pipe slide material	Pipe slide code	Pipe slide surface	Code for surface	Bolts and nuts	Code for bolts and nuts
S235JR (St37)	W37	untreated	OR	Strength class 8.8, galvanised	SG
		hot-dip galvanised	OF	Strength class 8.8, hot-dip galvanised	SF

Ordering example: Twin-stay slide guide made from S235JR (St37) with 2 pipe clamps, pipe slide hot-dip galvanised, with hot-dip galvanised bolts and nuts, strength class 8.8, for pipe outer diameter of 406.4 mm.

Part no: 116315 Type: DS-2-W37-OF-SF-406.4

 Pipe guide with polyamide sliding surface as well as other versions available upon request.

Pipe slides type DS-2 with two pipe clamps, DIN 3567

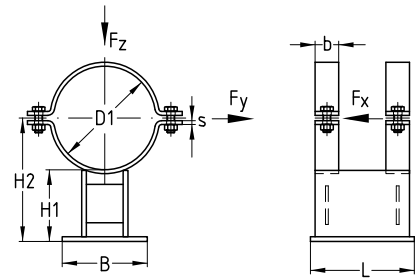

Nominal size DN	Pipe outer diameter D1 [mm]	Dimensions [mm]						Loading			Weight [kg/piece]			
		s	b	L	B	H1	H2	F _x [kN]	F _y [kN]	F _z [kN]				
175	191.0	8	50	220	180	150	246	12.0	12.0	24	13.700			
	247						13.760							
200	216.0						60	260	220	258	14.0	14.0	28	14.200
	260									14.300				
250	267.0	284	17.0	17.0	34	18.650								
	273.0	287				18.790								
300	315.0	10	70	300	300	308				19.0	19.0	38	20.370	
	323.9					312							20.580	
350	355.6					328				20.5	20.5	41	21.440	
	368.0					334							21.910	
400	406.4					353	21.5	21.5	43	33.530				
	419.0					360				34.030				
500	508.0					404	23.0	23.0	46	37.270				
	521.0					411				37.920				
600	610.0					455	25.0	25.0	50	41.470				