

Single bossed clamps with DÄMMGULAST® red, galvanised

Field of application

- Suitable for pipelines with dynamic loads in combination with expansion points
- Suitable for fixings in housing and industrial areas
- Suitable for fixings in industrial areas as well as in air-conditioning, ventilation and sanitary areas and thermal oil pipes
- Attachment of pipelines in increased temperature ranges
- For indoor use

Advantages

- Proven two-piece single bossed clamp
- The 2 locking screws allow adjustment to accommodate a greater variation in pipe diameter
- With **high-temperature resistant DÄMMGULAST® Vibration control lining red**

- The high-quality DÄMMGULAST® section maintains its properties in the **temperature range -60 °C to +220 °C**
- Average sound level improvement up to 24 dB(A)
- Tightening bolts with combination cross-head convenient for power driver
- Tightening bolts secured with captive washers
- Heavy-duty type with high load capacity due to creased shape
- Acoustic insulation, positive-fit liner with wide clip-over edges prevent the lining from slipping out of the pipe clamp
- This product is awarded with the „Gütezeichen Rohrbefestigung“ (quality mark of pipe support) up to size ≤ 200 mm and is submitted to controls according to RAL-GZ 655-B



Features

Size	Max. recommended load [N]
3/8"-2"	1,300
70-83 mm	1,900
3"-4"	2,200
125 mm-6"	2,700
170-200 mm	3,500
212-225 mm	5,300

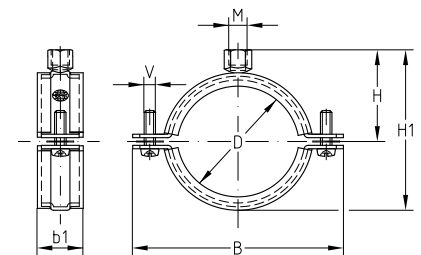
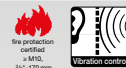

Connecting thread	Size		Clamping range [mm]	Part no.	Sales unit	Pack unit	Dimensions [mm]				
	[inch]	[mm]					B	b1	H1	H	V
M8/M10	3/8"		14-20	151532	100	pieces	64	23	55	35.5	M6 x 20
			21-26	151533			71		61	38.5	
	1/2"		26-30	151534	50		75		65	40.5	M6 x 25
			31-38	151535			81		71	43.5	
	1 1/4"		40-47	151537			91		81	48.5	M6 x 25
			48-54	151538			100		89	52.5	
	1 1/2"	57	54-60	151539			105		94	55.0	M8 x 35
			60-66	151540			111		100	58.0	
	2"	70	68-73	151542			126	28	109	62.5	M8 x 35
			73-80	151543			131		114	65.0	
	2 1/2"	83	82-87	151544			142		124	70.0	M8 x 40
			87-94	151545			146		128	72.0	
	3"	102	99-104	151546			157		139	77.5	M8 x 40
			105-112	151547			166		148	82.0	
4"	110	112-118	151548			172		154	85.0		

! Single bossed clamps can be produced in all other pipe sizes and types according to customer specifications. For use in areas with requirements on the duration of fire resistance, the boundary conditions set out in the fire test report must be observed.

Single bossed clamps with DÄMMGULAST® red, galvanised

Connecting thread	Size		Clamping range [mm]	Part no.	Sales unit	Pack unit	Dimensions [mm]									
	[inch]	[mm]					B	b1	H1	H	V					
M8/M10	5	125	122-128	151549	50	pieces	182	28	164	90.0	M8 x 40					
		133	132-137	151550			191		173	94.5						
		137-142	151551	196			178		97.0							
		144	142-148	151552			202		184	100.0						
		150	149-156	151553			210		192	104.0						
	6	160	159-164	151554			218		200	108.0						
		164-169	151555	223			205		110.5							
		170	169-172	151556			225		207	111.5						
		M10/M12	¾	14-20			151557		100			64	22	60	40.5	M6 x 20
				21-26			151558					71		66	43.5	
26-30	151559			75	70	45.5										
1	31-38		151560	50	81	76	48.5	M6 x 25								
	40-47		151562		91	86	53.5									
1½	48-54		151563		100	94	57.5	M6 x 25								
	54-60		151564		105	99	60.0									
2	60-66		151565		25	111	105	63.0			M8 x 35					
	68-73		151567			126	114	67.5								
2½	73-80		151568			25	131	119			70.0	M8 x 35				
	82-87	151569	142				129	75.0								
3	87-94	151570	25				146	133	77.0	M8 x 40						
	99-104	151571					157	144	82.5							
4	105-112	151572		25			166	153	87.0	M8 x 40						
	112-118	151573					172	159	90.0							
5	122-128	151574					25	182	169	95.0	M8 x 40					
	132-137	151575						191	178	99.5						
6	137-142	151576			25			196	183	102.0	M8 x 40					
	142-148	151577						202	189	105.0						
7	149-156	151578				25		210	197	109.0	M8 x 40					
	159-164	151579						218	205	113.0						
8	164-169	151580	25					223	210	115.5	M8 x 40					
	169-172	151581						225	212	116.5						
9	177-183	151582		25				235	223	122.0	M8 x 40					
	197-203	151583						256	243	132.0						
10	208-214	151584					25	284	256	138.5	M10 x 40					
	217-225	151585						295	267	144.0						
11	225-232	151586			25			304	274	147.5	M10 x 40					
	137-142	151587						50	196	28		187	106.0	M8 x 40		
5	142-148	151588				202			193		109.0					
	149-156	151589				210			201		113.0					
6	159-164	151590	218			209			117.0							
	164-169	151591	223			214			119.5							
7	169-172	151592	225	216		120.5										
	177-183	151593	235	227		126.0										
8	197-203	151594	256	247		136.0										
	208-214	151595	284	260		142.5										
9	217-225	151596	295	271	148.0											
	225-232	151597	304	278	154.0											



Single bossed clamps can be produced in all other pipe sizes and types according to customer specifications. For use in areas with requirements on the duration of fire resistance, the boundary conditions set out in the fire test report must be observed.