

### Duct joint clamps

#### Field of application

- Simple and quick flange connection for large cross-section ducts and high pressure conditions

#### Advantages

- No pre-clamping or drilling required
- Supplied with hexagon head bolt already inserted
- High load capacity due to reinforcing rib

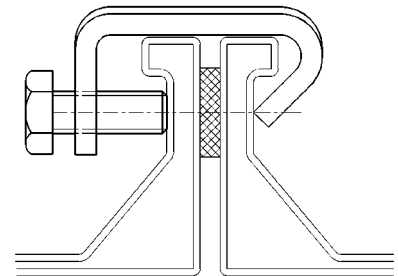
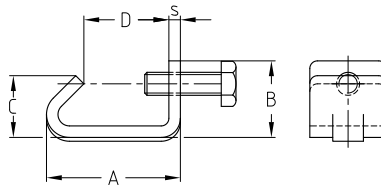

Type	Hexagon head bolts	Part no.	Sales unit	Pack unit	Dimensions [mm]				
					A	B	C	D	s
galvanised	M8/20	116570	100	pieces	35	20	17	23	3.0 x 30
		116576			31	23		18	4.0 x 30
	M8/25	116573			35	20	14	23	3.0 x 30
V2A	M8/20	116567			33	18		23	3.0 x 30



Normally recommended spacing 300–400 mm. For ducts with a side length of less than 800 mm, one clamp needs to be mounted in center of each side.