

MPC-Wall hanger brackets

with lateral slot, galvanised

Field of application

- Ideal as cantilever support structure for riser pipes
- Applicable in combination with saddle support and channel support brackets as a cross-beam for pipe attachments in shafts and ducts
- Applicable as a cantilever bracket for supporting air ducts

Advantages

- The strong base plate ensures a high load carrying capacity
- The vertical and horizontal holes in the base plate allow easy height adjustment of the bracket
- Fixing in the side slot of the support channel allows simple alignment of parallel pipelines
- Clean-cut appearance by the use of MPC-protection caps

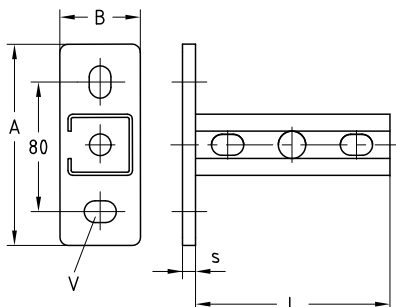

For support channels	Length L [mm]	Part no.	Sales unit	Pack unit	Dimensions [mm]			
					A	B	s	V
27/18	600	156777	20	pieces	120	40	4	11 x 19
28/30	400	156778					5	
38/40	240	156779			125	50	8	13.5 x 20
	480	156780						