

### MPC-Saddle supports galvanised

#### Field of application

- Simple assembly of strong cross-beams using MPC-Support channels
- Applicable for cramped installation conditions in shafts and ducts

#### Advantages

- The vertical and horizontal holes in the base plate enable simple alignment of the MPC-Saddle support
- Good load transfer due to the high bending stiffness of the saddle connection
- Ideal connecting element for channel section structures
- The section 38/80 provides torque-resistant support as channel is encompassed on both sides



MPC-Saddle support, crosswise



MPC-Saddle support, lengthwise



MPC-Saddle support lengthwise pre-assembled with double rail nut



MPC-Saddle support, lengthwise for profiles 38/80, 40/80 and 40/120

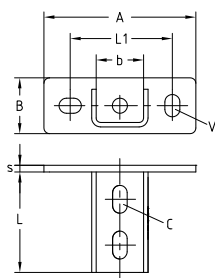

MPC-Saddle support, crosswise

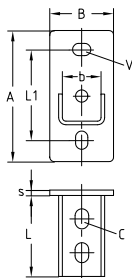

MPC-Saddle support, lengthwise

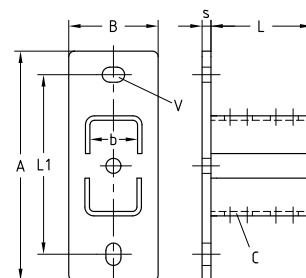

MPC-Saddle support, lengthwise for profiles 38/80 and 40/120

#### Features



	Description	For support channels	Part no.	Sales unit	Pack unit	Dimensions [mm]							
						A	B	b	L	L1	s	C	V
<b>MPC-Saddle supports</b>	Crosswise	27/18, 28/30	<b>156818</b>	30	pieces	125	50	30	70	80	5	11 x 19	11 x 19
		38/24–40/80	<b>156816</b>	25		136		42	90	91.5	6	13 x 25	13.5 x 20
	Lengthwise	27/18, 28/30	<b>156811</b>	30		125		30	70	80	5	11 x 19	11 x 19
		38/24–40/60	<b>156809</b>	25		144	70	42	90	100	6	13 x 25	13.5 x 20
		38/80, 40/80	<b>156812</b>	1		205	80			160	8		
		40/120	<b>156813</b>			245				200			
<b>MPC-Saddle supports, pre-assembled with double rail nut</b>	Crosswise	38/24–40/80	<b>156817</b>	25		136	50			91.5	6		
	Lengthwise	38/24–40/60	<b>156810</b>			144	70			100			

MPC-Doublerail nut, please refer to page 4/22.