

Trapezoid-sheet hanger

with clearance hole, hot-dip galvanised

Field of application

- For the professional attachment of installations to trapezoidal sheets

Advantages

- Attachment using sealing rivets or self-drilling screws to the stays of the corrugations
- Easy to adapt to different trapezoidal sheet sections due to predetermined bending points

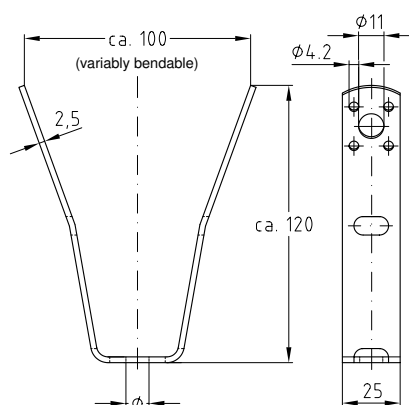

Features

Max. recommended load [N]
1,300



For attachment on trapezoidal sheet metal according to building inspection approval Z-14.1-4 sealing rivets of Ø 4.0 mm AlMg 5 (DIN 1725) or drilling screws of Ø 4.2 mm made of case hardened steel are to be used. The max. permitted load according to the approval depends on thickness of particular trapezoidal sheet metal. Please refer to chapter "Ventilation" for approved drilling screws.

Type	Part no.	Sales unit	Pack unit
M10	130195	100	pieces



Please refer to chapter "Tools" for trapezoid-sheet pliers used for attachment.

