

## MPR-Saddle support type S+1

hot-dip galvanised

### Field of application

- Simple assembly of strong cross-beams using MPR-Support channels
- Applicable for cramped installation conditions in shafts and ducts
- For indoor and outdoor use

### Advantages

- Easily connected with the MPR-Support channels due to installation with the MPR-Connection lock type S+
- Good load transfer due to the high bending stiffness of the saddle connection
- Ideal connecting element for channel constructions
- Elongated- and cross-holes for direct attachment to the building structure

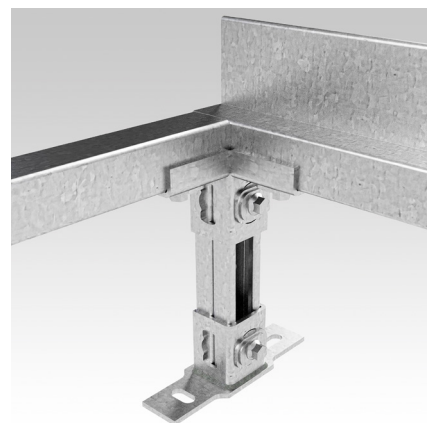
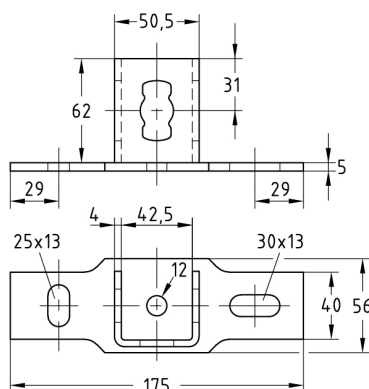

For support channels	Part no.	Sales unit	Pack unit
41/21-41/62	176258	10	Pieces

