

STATO® Brackets  
galvanised

Field of application

- Stable support system with high load-bearing capacity for pipe installations
- Ideal pipe anchor point in combination with STATO® Clamps without lining**
- Ideal as height adjustable subframe for anchor and expansion assemblies
- Ideal as **anchor point for insulated chilled water pipes in combination with wooden blocks and STATO® Clamps**

Advantages

- Continuously adjustable in height and slope
- As height adjustment for waste water pipes or to compensate for unevennesses
- Can be fitted with up to 3 STATO® Clamps in case of heavy loads
- Especially suitable for heavy pipes with large wall clearances
- Can be used as bearing block, adjustable in height and slope

The complete kit consists of:

- 4 STATO® Angle pieces
- 6 Coach bolts M12
- 6 Hex. nuts M12
- 6 Washers for M12

All parts are galvanised.



STATO® Clamps with adjustable STATO® Bracket

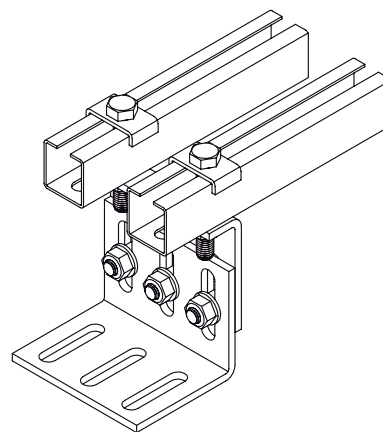

Height adjustable sub-frame for anchor and expansion assemblies

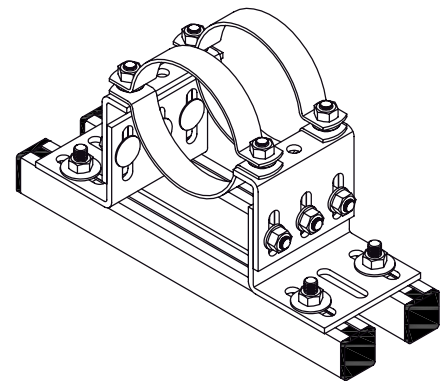

Free slidable elevation

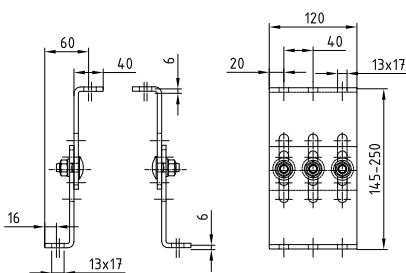

Slim version

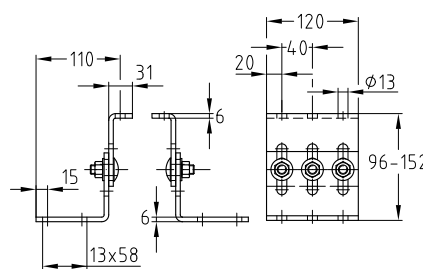

Standard version

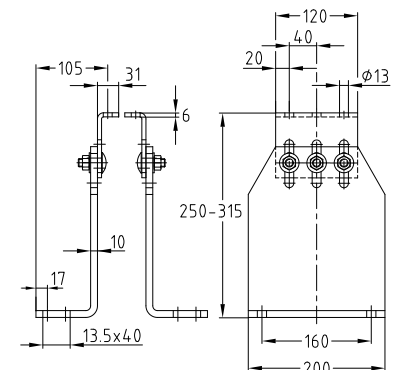

Heavy-duty version, larger distance from structure

| Type               | Overall height [mm] |      | Adjustment range [mm] | Part no. | Sales unit | Pack unit |
|--------------------|---------------------|------|-----------------------|----------|------------|-----------|
|                    | min.                | max. |                       |          |            |           |
| Slim version       | 145                 | 250  | 105                   | 129171   | 5          | pieces    |
| Standard version   | 96                  | 152  | 56                    | 129167   |            |           |
| Heavy-duty version | 250                 | 315  | 65                    | 129176   | 1          |           |

## STATO® Brackets galvanised

### Features

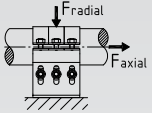
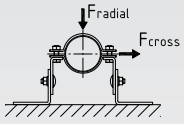
| Type  |        | Slim version        | Standard version | Heavy-duty version | Tightening torque [Nm]<br>(valid for M12, steel pipes without coating) |        |
|---|--------|---------------------|------------------|--------------------|--|--------|
| Max. recommended load [N]<br><br><br><br> | axial  | 5,500 per clamp     | 5,500 per clamp  | 5,500 per clamp    | 75   |        |
|   | cross  | min. overall height |                  |                    |  |        |
|   |        | 6,000               | 8,000            | 7,000              |  |        |
|   |        | max. overall height |                  |                    |  |        |
|   |        | 3,000               | 6,000            | 7,000              |  |        |
|   | radial | min. overall height | 25,000           |                    |  | 25,000 |
|   |        | 20,000              |                  |                    |  |        |
|   |        | max. overall height |                  |                    |  |        |
|   |        | 10,000              |                  |                    |  |        |

#### VIDEO TIP

 **Installation of anchor points with MÜPRO STATO® brackets:** the video shows the installation options in industrial settings and plant design and explains the individual installation steps.

