

BZ Heavy-duty anchors

Field of application

- For anchorages of medium-weight and heavy loads in cracked and non-cracked concrete
- Attachment of wall hanger brackets, support channels, ground plates, constructions made of metal and wood, cable ducts, etc.
- Also applicable in hard natural stone

Advantages

- Secure anchorage due to slit splaying sleeve with serrations
- Force-controlled splaying from the tightening torque
- Secure splaying due to taper with slide coating
- European Technical Assessment (ETA) for cracked concrete (tensile zone) and non-cracked concrete (compression zone)
- Higher loading possible when used in the compression zone
- Two effective anchorage depths for greater flexibility (maximum anchor length 210 mm)
- Approved for seismic loads, performance categories C1 and C2 (maximum anchor length 210 mm)
- Also available in HCR upon request

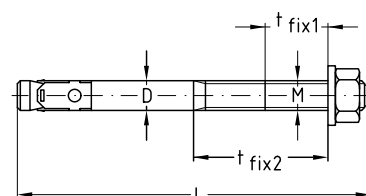





Standard anchorage depth:

Type	Connecting thread	Clamping thickness t_{fix1} [mm]	Drill hole- \varnothing x depth [mm]	Setting depth h_{nom} [mm]	Anchoring depth h_{ef} [mm]	Seismic	Anchor length L [mm]	Material	Part no.	Sales unit	Pack unit
BZ 8-30-41/95	M8	30	8 x 60	52	46	-	95	V4A	162179	100	pieces
BZ 8-50-61/115		50					115		162180		
BZ 10-10-30/90	M10	10	10 x 75	68	60	C1/C2	90		162181	50	
BZ 10-30-50/110		30					110		162182		
BZ 10-50-70/130		50					130		162183		
BZ 12-15-35/110	M12	15	12 x 90	80	70		110		162184	25	
BZ 12-50-70/145		50					145		162185		
BZ 12-85-105/180		85					180		162186		

Reduced anchorage depth:

Type	Connecting thread	Clamping thickness t_{fix2} [mm]	Drill hole- \varnothing x depth [mm]	Setting depth $h_{nom red}$ [mm]	Anchoring depth $h_{ef red}$ [mm]	Anchor length L [mm]	Material	Part no.	Sales unit	Pack unit
BZ 8-30-41/95	M8	41	8 x 49	41	35	95	V4A	162179	100	pieces
BZ 8-50-61/115		61				115		162180		
BZ 10-10-30/90	M10	30	10 x 55	48	40	90		162181	50	
BZ 10-30-50/110		50				110		162182		
BZ 10-50-70/130		70				130		162183		
BZ 12-15-35/110	M12	35	12 x 70	60	50	110		162184	25	
BZ 12-50-70/145		70				145		162185		
BZ 12-85-105/180		105				180		162186		

BZ Heavy-duty anchors

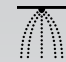
Features					    		
Type	FM	Standard anchorage depth			Reduced anchorage depth		
		Anchoring depth h_{ef} [mm]	Permissible tensile load ¹⁾ cracked concrete C20/25 [kN]	Permissible tensile load ¹⁾ uncracked concrete C20/25 [kN]	Anchoring depth $h_{ef\ red}$ [mm]	Permissible tensile load ¹⁾ cracked concrete C20/25 [kN]	Permissible tensile load ¹⁾ uncracked concrete C20/25 [kN]
BZ 8-30-41/95		46	2.4	5.7	35	2.4	3.6
BZ 8-50-61/115							
BZ 10-10-30/90	●	60	4.3	7.6	40	3.6	4.3
BZ 10-30-50/110	●						
BZ 10-50-70/130	●						
BZ 12-15-35/110	●	70	7.6	11.9	50	6.1	8.5
BZ 12-50-70/145	●						
BZ 12-85-105/180	●						

¹⁾ The approved loading applies for single anchors in concrete strength class \geq C20/25 (B25) for axially applied tension without the influence of axial and edge spacings. The safety coefficient according to ETAG is included. The European Technical Assessment ETA-05/0158 shall be observed in dimensioning.



Please refer to chapter "Technical information" for additional characteristic values of plugs.

