

Hollow-core slab ceiling anchors

type Easy for anchoring in prestressed concrete hollow-core slab ceilings

Field of application

- Special anchor for suspension in prestressed concrete hollow-core slab ceilings

Advantages

- Flexible application in combination with threaded rods or hexagon head bolts
- Approved by the building authorities
- Secured function in the hollow core and in the solid material
- Quick and easy to install
- Flush with the surface of the building component
- For material thicknesses of up to 50 mm
- Approved by the VdS (Verband der Schadenversicherer) / Association of Indemnity Insurers

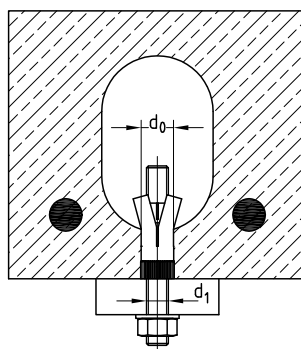
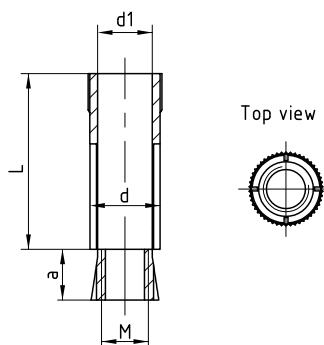

Application of the hollow-core slab ceiling anchor in the hollow core of the prestressed concrete ceiling slab

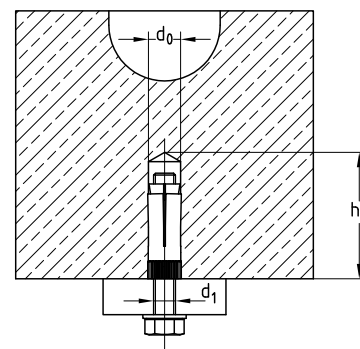

Application of the hollow-core slab ceiling anchor in the solid material of the prestressed concrete ceiling slab

Features



Connecting thread	Sleeve length L [mm]	Drilled hole- Ø d ₀ [mm]	Drilled hole depth h ₀ [mm]	Part no.	Sales unit	Pack unit	Max. allowable load ¹⁾ [kN] for material thickness			
							25 [mm]	30 [mm]	40 [mm]	50 [mm]
M8	35	12	55	116773	50	pieces	0.7	0.9	2.0	3.6
M10	40	16	60	116767			0.9	1.2	3.0	
M12	45	18	70	116770	25		1.0			4.3

¹⁾ The admissible loads apply for single anchors in prestressed concrete hollow-core slab ceilings of strength class C45/55 for axially applied tension, lateral load and inclined load at any angle without the effect of axial and edge clearances. The safety coefficient according to ETAG is included.
The construction approval of the building inspectorate DIBt shall be observed for dimensioning.