

Threaded pins

DIN 976, hot-dip galvanised

Connecting thread	Length [mm]	Part no.	Sales unit	Pack unit
M12	100	113879	100	pieces
	150	113912		
	200	113924	50	
	250	113945		
	300	113951		



i For threaded pins with left-hand and right-hand thread please refer to chapter „Accessories“.

Turnbuckles

DIN 1480, hot-dip galvanised

Connecting thread	Overall length [mm]	Adjustment range [mm]	Part no.	Sales unit	Pack unit
M12	125	80	125010	25	pieces
M16	170	110	125016		



Washers

DIN 125, hot-dip galvanised

For thread	Outer diameter [mm]	Thickness [mm]	Part no.	Sales unit	Pack unit
M8	16	1.6	127346	100	pieces
M10	20	2.0	127318		
M12	24	2.5	127325		
M16	30	3.0	127328		



Washers

for MPC-Support channels, hot-dip galvanised

For thread	Outer diameter [mm]	Thickness [mm]	Part no.	Sales unit	Pack unit
M10	30	2.5	132832	100	pieces



Washers

for MPR-Support channels, mechanically galvanised

For thread	Outer diameter [mm]	Thickness [mm]	Part no.	Sales unit	Pack unit
M8	40	3	154239	100	pieces
M10			154240		
M12			154241		
M16			154242	50	

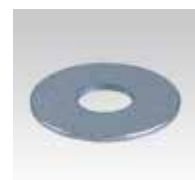

Link chain

DIN 763, hot-dip galvanised

Size [mm]	Length [m]	Part no.	Sales unit	Pack unit
4 x 32	30	112096	1	pieces

