

**ML-Clamping body**

without clamping set and clamping strap, for ML-Strap clamps

Design	Surface	For clamping set	Hole spacing [mm]	Part no.	Sales unit	Pack unit
No. 701	hot-dip galvanised	M8	60-80	124969	100	Pieces
No. 702		M10	70/100	124975		
No. 704	untreated		-	124993		



No. 702

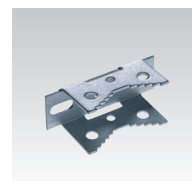

No. 701



No. 704

**ML-Clamping straps**

for ML-Strap clamps, in dispenser

Design	Surface	Width [mm]	Length [m]	Thickness [mm]	Part no.	Sales unit	Pack unit
No. 706	V2A	29	25	0.6	118398	1	Roll
No. 707	galvanised				118402		

**Clamping sets**

for ML-Clamping bodies

Design	Size	Suitable for	Part no.	Sales unit	Pack unit
Clamping screw no. 708-1	M8 x 45 mm with slot	ML-Clamping body no. 701	125034	100	Pieces
Clamping screw no. 708-2	M8 x 45 mm without slot		121155		
Hexagonal nut M8	M8		105498		
Clamping screw no. 709-1	M10 x 45 mm with slot	ML-Clamping body no. 702	125037		
Clamping screw no. 709-2	M10 x 45 mm without slot		125040		
Hexagonal nut M10	M10		105433		



Clamping set for ML-Clamping body no. 701 consisting of:

1 clamping screw M8 with slot, 1 clamping screw M8 without slot, 2 hexagonal nuts M8

Clamping set for ML-Clamping body no. 702 consisting of:

1 clamping screw M10 with slot, 1 clamping screw M10 without slot, 2 hexagonal nuts M10

