

### Zykon steel hammerset anchors FZEA

galvanised

#### Application

- For form-locking anchoring in undercut of cracked and non-cracked concrete
- Also applicable in hard natural stone

#### Your advantages

- European Technical Assessment for cracked and non-cracked concrete
- Form-locking in the undercut for additional security
- Only low anchoring depth required
- Almost splay-free function permits low axial spacing and edge spacing
- Easy visual inspection of correct anchor set through impact embossing with the setting tool
- Single-stage drilling procedure with simultaneous production of the undercut saves installation time
- Also available in highly corrosion resistant material HCR (1.4529)

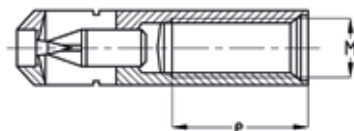

#### Features



Type	Connecting thread	Drilling diameter [mm]	Anchoring depth $h_{ef}$ [mm]	Screw-in depth $e$ [mm]	FM	Permissible load <sup>1)</sup>		Part no.	Sales unit	Pack unit
						Cracked concrete [kN]	Uncracked concrete [kN]			
10 x 40 M8	M8	10	40	11 - 17		1.6	3.6	107868	1	Pieces
12 x 40 M10	M10	12		13 - 19	x	3		107871		
14 x 40 M12	M12	14		15 - 21	x	3.6		107872		

<sup>1)</sup> The admissible loads apply for single anchors at concrete strength class > C20/25 (B25) for axial tension, without edge banding, that is without axis and edge distance. The European Technical Assessment requirements must be considered for dimensioning.

 These products are manufactured upon request. Delivery time depends on clarification of details and order quantity.

