

Swivel hangers

galvanised

Application

- Attachment solution for suspended pipes - allows axial and lateral pipe movements
- Attachment of pipes with thermal, axial expansion
- Especially suitable for large ceiling distances
- For the installation of swivel hangers together with MPR-Quick fasteners please follow the installation instructions accompanying the product

Your advantages

- 360° degree of freedom
- Large deflection from the vertical
- Appropriate threaded rod lengths allow the pipes to be set to the desired height
- Screw-in depth of thread hanger allows precise height adjustment
- Screw-in depth visible through inspection hole (long version)
- Short version for low overall height



Swivel hanger, short



Swivel hanger, long

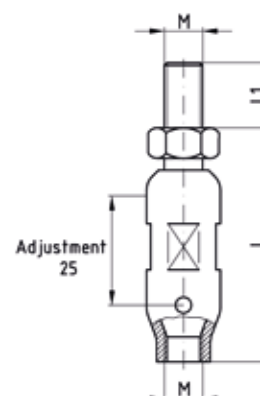
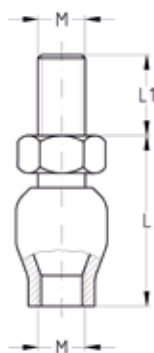

Features



Connecting thread	Max. recommended load [N]
M8	2,400
M10	3,000
M12	3,500



Design	Connecting thread	Length L [mm]	Thread length L1 [mm]	Deflection from the vertical	Height adjustment up to [mm]	Part no.	Sales unit	Pack unit
short	M8	34	18	up to 12°	-	120231	50	Pieces
	M10	70				120227		
long, with inspection hole	M8	35	57 18 20	up to 12°	25	120223	1 50	
	M10	61				120208		
	M12					120204		
	M10					120211		
long, greater deflection	M10	60	18	up to 22°		120196		



For secure tilt-free pipe guides two swivel hangers - one at the top and one at the bottom - must be considered for each attachment point. The threaded rod must be secured against loosening by the use of locknuts.