

## MPT-Consoles Q50

hot-dip galvanised

## Application

- Consoles for accommodation of pipelines and aggregates in industrial construction, plant building construction and heavy-duty building technology for attachment on floor, wall and ceiling

## Your advantages

- Baseplate for direct or indirect connection to the structure
- Quick fixing due to continuous mounting slot
- High corrosion protection due to standardised hot-dip galvanising ensures flexible implementation outdoors and indoors
- Clean-cut appearance by the use of MPT-protection caps

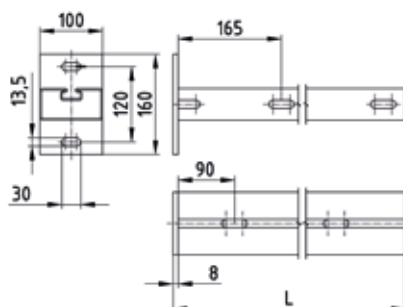

Profile	Length L [mm]	Thickness s [mm]	Weight [kg]	Part no.	Sales unit	Pack unit
Q50-2.5	500	8	4.5	147941	1	Pieces
	750		6.25	147942		
	1,000		7.95	147943		

## Technical data of brackets:

## Features

Profile	Base plates			MPT-Support channels	
	Dimensions H x W x D [mm]	Material	Admissible steel stress $\sigma_{adm}$ [N/mm <sup>2</sup> ]	Material	Admissible steel stress $\sigma_{adm}$ [N/mm <sup>2</sup> ]
Q50-2.5	160 x 100 x 8	S235	158	S235	158

## Load bearing capacities of brackets for bending around the y-axis:

Profile	Base plate $M_{max}$ [Nmm]	Length L [mm]	Max. recommended load [N]			
Q50-2.5	559,674	500				
		750	2,204	1,102	1,102	735
		1,000	1,441	721	721	480
			1,051	526	526	350



The determined loads apply for static loads. Calculation based on Eurocode (EC3).

The safety coefficient  $\gamma = 1.48$  takes into account the partial and combination coefficients as well as the safety factor of the material.

For the given values, the permissible steel stress and the maximum permissible deflection  $L/150$  are not exceeded, taking the deadweight into consideration.

The load-carrying values refer to the console support. Fastening elements such as plugs and screws, must be chosen in accordance with the loads.