

Mounting angles 90° galvanised

Application

- Solid fixing element for construction of pre-wall installations and shelves as well as for channel constructions for attachments of pipelines and air ducts without welding
- Also applicable for direct mounting on walls, ceilings or floors

Your advantages

- Variable fitting possibilities
- Versatile, e.g. as: support bracket, connecting element, angle bracket
- Multi-purpose component for professional, practical installation solutions
- Can be provided already pre-assembled with MPC-Double rail nut for the quick attachment within channel slot

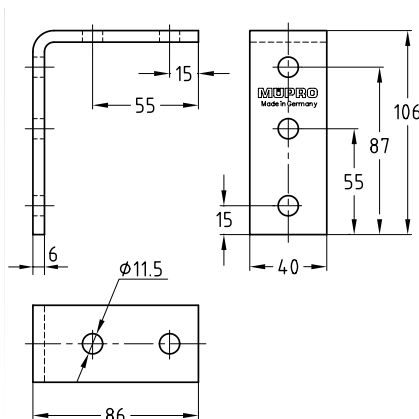

Mounting angle 90°

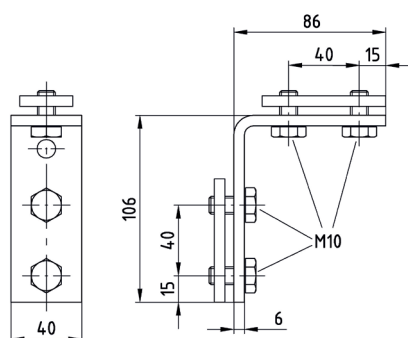

Mounting angle 90°, pre-assembled

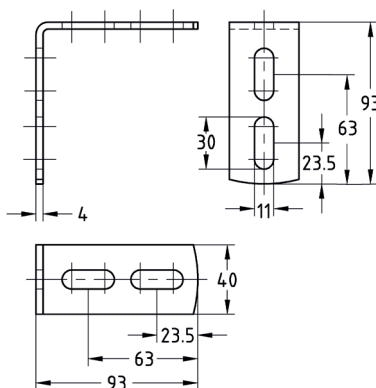

Mounting angle 90°, type 3, light

Design	For profiles	Suitable for	Part no.	Sales unit	Pack unit
90°	38/24-40/120	MPC	118808	10	Pieces
90°, pre-assembled			147764	25	
90°, type 3, light	38/24-40/120, 41/21-41/124	MPC/MPR	118906		