

## MPC-Channel support brackets

stainless steel

**Application**

- Ideal for attachment of MPC-Support channels as a cross-beam in shafts and ducts
- For right-angled connection of two channels where section slots do not have the same alignment
- Applicable as floor or ceiling mounting for vertical MPC-Support channels

**Your advantages**

- The vertical and horizontal holes in the base plate enable easy height adjustment of the MPC-Channel support bracket
- Supplied with two clamping bolts, pre-installed



MPC-Channel support bracket, crosswise



MPC-Channel support bracket, lengthwise

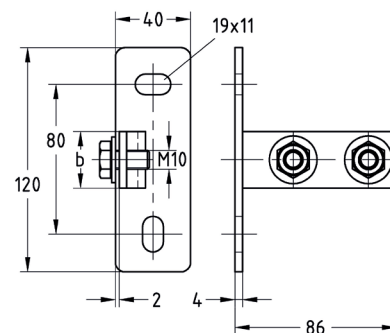
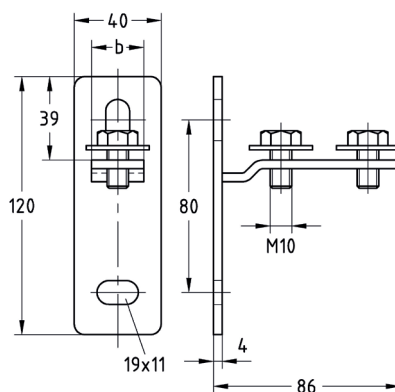

Design	For profiles	Dimensions b [mm]	Material V2A Part no.	Material V4A Part no.	Sales unit	Pack unit
crosswise	27/18, 28/30	24	156801	156805	10	Pieces
	38/40	30	156803	156807		
lengthwise	27/18, 28/30	24	156800	156804		
	38/40	30	156802	156806		