

MPC-Wall hanger bracket

for the attachment on support channels, hot-dip galvanised

Application

- Wall hanger bracket with solid, rounded-edge base plate for the attachment on support channels
- Solid cantilever construction due to support from diagonal strut

Your advantages

- Clip-over edges of the base plate for good appearance
- Variety of set lengths covers all constructional requirements
- Simple height adjustment when mounted in the channel slot
- Clean-cut appearance by the use of MPC-protection caps

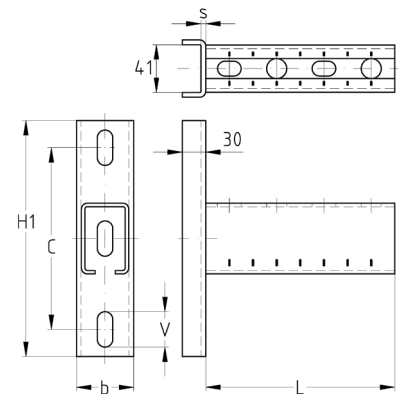

For profiles	Length L [mm]	Dimensions [mm]					Part no.	Sales unit	Pack unit
40/60	800	b	C	H1	s	V	139505	1	Pieces
		49	154	200	4	13 x 30			



See MPC-Wall hanger bracket 40/60 for load-bearing capacities. When mounted in the channel slots, the max. recommended shear and tensile loads for the accessories (e.g. MPC-Hammer head bolts) must be observed.

