

MPC-Wall hanger brackets

hot-dip galvanised

Application

- Ideal as cantilever support structure of multisection pipeways
- Applicable as cantilever bracket for air ducts and cable trays
- Applicable in combination with saddle support and channel support brackets as a cross-beam for pipe attachments in shafts and ducts
- Solid wall bracket for valves and equipment
- The 38/80 profile is ideally suitable for double-sided installation of pipe sections due to double channel slots
- Suitable for outdoor use

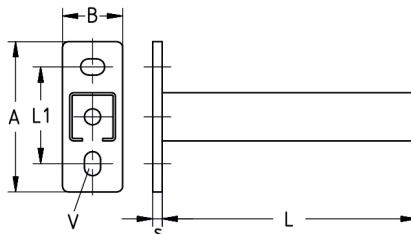

Your advantages

- The strong base plate ensures a high load carrying capacity
- The vertical and horizontal holes in the base plate allow easy height adjustment of the bracket
- Variety of lengths covers all construction requirements
- Clean-cut appearance by the use of MPC-protection caps

Profile	Length L [mm]	Dimensions [mm]					Part no.	Sales unit	Pack unit
		A	B	L1	s	V			
27/18/1.25	300	120	40	80	4	11 x 19	156731	1	Pieces
38/40/2.0	240	125	50	80	8	13.5 x 20	156732		
	320						156733		
	400						156734		
	480						156735		
	560						156736		
	640						156737		
	800						156738		
	1,040						156739		
40/60/3.0	560	165	60	120			156740		
	800						156741		
	1,040						156742		



MPC-Wall hanger brackets

hot-dip galvanised

Technical data of brackets:

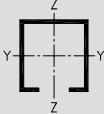
Features					
Profile	Base plates			MPC-Support channels	
	Dimensions H x W x D [mm]	Material	Admissible steel stress $\sigma_{adm.}$ [N/mm ²]	Material	Admissible steel stress $\sigma_{adm.}$ [N/mm ²]
27/18	120 x 40 x 4	S355MC	231	DC01	153
38/40	125 x 50 x 8	S235	162	DD11	
40/60	165 x 60 x 8	S355MC	231		

Load bearing capacities of brackets for bending around the y-axis:

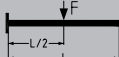
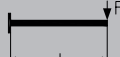
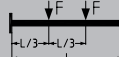
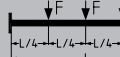
Profile	Base plate $M_{max.}$ [Nmm]	Length L [mm]	Max. recommended load [N]			
						
27/18	52,255	300	311	156	156	104
38/40	260,845	240	2,173	1,086	1,086	724
		320	1,630	815	815	543
		400	1,304	652	652	434
		480	1,086	543	543	362
		560	931	465	465	310
		640	815	407	407	271
		800	652	279	326	217
		1,040	501	161	242	156
40/60	514,741	560	1,838	919	919	612
		800	1,286	643	643	428
		1,040	989	494	494	329



The determined loads apply for static loads. Calculation based on Eurocode (EC3).

The safety coefficient $\gamma = 1.54$ takes into account the partial and combination coefficients as well as the safety factor of the material.

For the given values, the permissible steel stress and the maximum permissible deflection $L/150$ are not exceeded, taking the deadweight into consideration.

The load-carrying values refer to the console support. Fastening elements such as plugs and screws, must be chosen in accordance with the loads.



For further technical information please refer to chapter „Technical information“.

