

MPC-Wall hanger brackets

with lateral slot, galvanised

Application

- Ideal as cantilever support structure for riser pipes
- Applicable in combination with saddle support and channel support brackets as a cross-beam for pipe attachments in shafts and ducts
- Applicable as a cantilever bracket for supporting air ducts

Your advantages

- The strong base plate ensures a high load carrying capacity
- The vertical and horizontal holes in the base plate allow easy height adjustment of the bracket
- Fixing in the side slot of the support channel allows simple alignment of parallel pipelines
- Clean-cut appearance by the use of MPC-protection caps

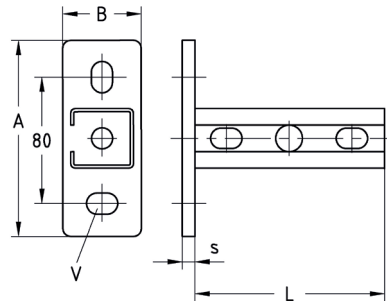

Profile	Length L [mm]	Dimensions [mm]				Part no.	Sales unit	Pack unit
		A	B	s	V			
27/18/1.25	600	120	40	4	11 x 19	156777	20	Pieces
28/30/1.75	400			5		156778	25	
38/40/2.0	240	125	50	8	13.5 x 20	156779	20	
	480					156780		
	720					160211	1	