

MPR-3D-Connectors type S+1

hot-dip galvanised

Application

- Fasteners for three-dimensional structures e.g. in shelves and rail constructions
- For indoor and outdoor use

Your advantages

- Fast and simple installation of three-dimensional connections joints in combination with the MPR-Connection lock type S+
- Flexible arrangement of the rail slot on MPR-Support channels 41/21-41/41 with MPR-3D-Connectors type S+1
- Applicable for cramped installation conditions

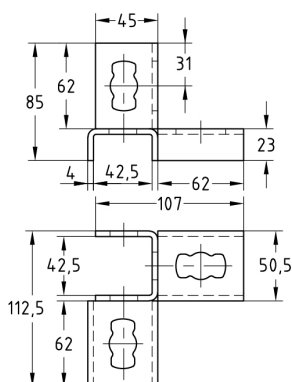
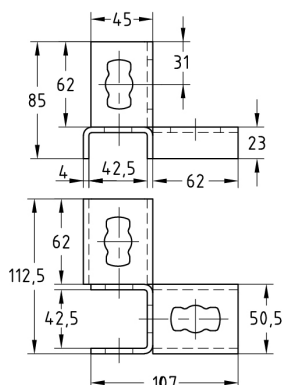

MPR-Corner connector left type S+1



MPR-Corner connector right type S+1



Design	For profiles	Part no.	Sales unit	Pack unit
Corner connector left	41/21, 41/41	176254	10	Pieces
Corner connector right		176255		

